

1 SITE PLAN ENLARGED - SPACES 16 - 22  
SCALE: 1/8" = 1'-0"

- NOTES:**
- CONTRACTOR TO CONFIRM RV SITE LAYOUTS IN FIELD w/ ARCHITECT & OWNER PRIOR TO STARTING CONSTRUCTION OF SLABS AND UTILITIES.
  - PROVIDE 24" x 24" x 4" CONCRETE PAD @ BASE OF EA. ELECTRICAL PEDESTAL.
  - PROVIDE GRAVEL PAVEMENT AT REMOVED SLAB AND FENCE LOCATIONS.
  - BLEND & SMOOTH (E) & (N) GRAVEL PAVING FROM EDGE OF (E) ASPHALT PAVING TO EDGE OF (E) ASPHALT PAVING.

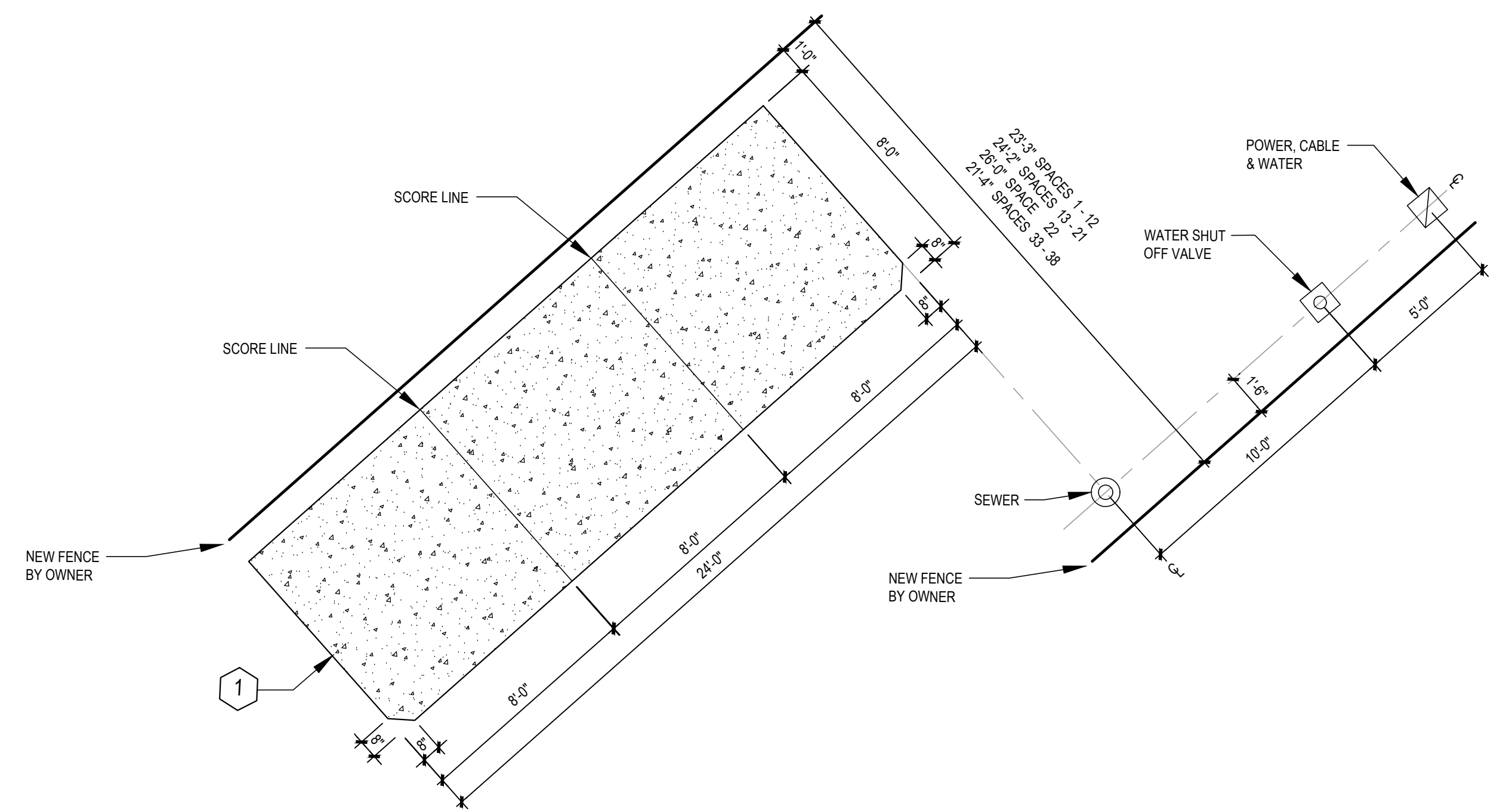

2 TYPICAL UTILITY & SLAB LAYOUT FOR MODIFIED AND NEW SITES  
SCALE: 1/4" = 1'-0"

**GENERAL NOTE:**

- ASBESTOS ABATEMENT HAS BEEN COMPLETED ON (E) STRUCTURES TO BE REMOVED. SURVEY & ABATEMENT INFORMATION & DISPOSAL CERTIFICATES ARE AVAILABLE UPON REQUEST.

**KEYNOTES:**

- 6" CONC. SLAB WITH #4s @ 12" O.C. EA. WAY. SET NEW SLAB FLUSH w/ TOP OF GRAVEL PAVEMENT. SEE 2143 FOR SLAB AND UTILITY LAYOUT.

**LEGEND**

	POWER PANEL, CABLE & WATER
	WATER SHUT OFF VALVE
	SANITARY SEWER CONNECTION
	FENCE & CONC. TO BE REMOVED
	NEW FENCE - PROVIDED BY OWNER
	EXISTING SURFACE ELEVATION

REF.# + ELEV.# TYPE

125 WEST CENTRAL AVENUE  
SUITE 400  
COOS BAY, OREGON 97420  
TEL: (541) 268-9888  
www.crowclay.com

**CROW/CLAY & ASSOCIATES INC.**  
ARCHITECTURE AND PLANNING  
LAND USE AND INTERIORS

REGISTERED ARCHITECT  
MICHAEL R. CROW  
Michael R. Crow  
COOS BAY, OREGON  
STATE OF OREGON

**PORT OF BROOKINGS HARBOR**  
BEACHFRONT RV PARK IMPROVEMENTS  
16024 BOAT BASIN ROAD  
BROOKINGS, OREGON 97415

**REVISIONS**

No.	Revision:	Date:

AUGUST 2021  
PROJECT NO: 19005

**A3**